

## PRODUCT DATA SHEET – Tool ThermoDrive V2

### Sekcja 1. PRODUCT DESCRIPTION

#### SETTING TOOL FOR ThermoDrive V2



Tool ThermoDrive V2 is dedicated for optional immersed mount of ThermoDrive V2 fasteners for fixing thermal insulation material realised by screwing. Installation of fasteners using Tool ThermoDrive V2 and polystyrene discs (KS/KSG) or mineral wool discs (EDMW) minimizes spot thermal conductivity and makes preparation of surface for final finishing of the facade much easier and faster.

#### Tool ThermoDrive V2



### Sekcja 2. EXAMPLE INSTALLATION

- Example of immersed mount of fastener **ThermoDrive V2** using **Tool ThermoDrive V2** and insulation material disc

III. INSTALLATION INSTRUCTION - IMMERGED MOUNT USING TOOL THERMODRIVE-V2 WITH INSULATION CAP

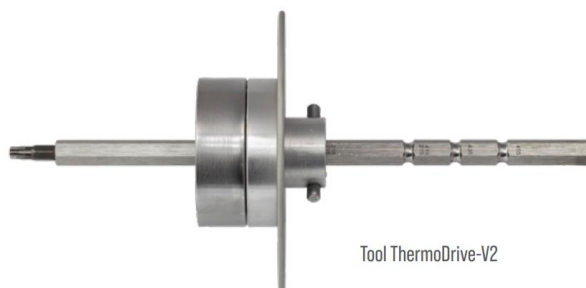
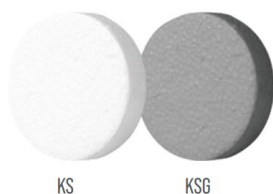
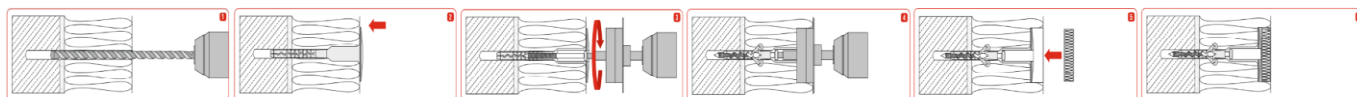

### Sekcja 3. TECHNICAL DATA

TECHNICAL PARAMETERS		
Product Code	Diameter [mm]	Length [mm]
TOOL-THERMODRIVE-V2	120	250

### Sekcja 4. REMARKS

- All previous versions of this Product Data Sheet shall cease to be valid
- Data given in this Product Data Sheet is in accordance with current knowledge and published in good faith. KLIMAS Sp. z o.o. is not responsible for correctness and quality of the fixing if recommendations regarding method of use and installation are not followed.