

PRODUCT DATA SHEET – SFXL/SFXC/SFXO

Section 1. PRODUCT DESCRIPTION

UNIVERSAL PLUG WITH STRAIGHT/ROUND HOOK/EYE-BOLT – SFXL/SFXC/SFXO

Universal plug SFXL/SFXC/SFXO comprises sleeve made of polyamide and steel screw with straight/round hook/eye-bolt hook with protective zinc coating. It is designed for fixing of light-duty interior finish systems and lightweight installations on all building substrates. The sleeve has ribs and stabilising fins which prevent rotation of sleeve during installation and provide initial fixation in the substrate. Unique shape of the sleeve allows for installation in both solid materials (by expansion of the sleeve) and materials with voids (by shape fixation provides a “knot” formation).

Types of substrates on which universal plug SFXL/SFXC/SFXO can be installed:

- Concrete
- Solid clay brick and sand-lime brick
- Hollow clay brick
- Hollow sand-lime brick
- Autoclaved aerated concrete
- Fibre-cement board, plasterboard

Universal plugs hold National Technical Assessment:
ITB-KOT-2021/1847 edition 1



Section 2. METHOD OF INSTALLATION

1. Original plugs delivered by the manufacturer can be used only
2. Before installation identify a substrate in which the plug will be installed and compare loads which the plug will carry to resistance values given in National Technical Assessment
3. Select adequate length of plug (sleeve + screw)
4. Use proper method of drilling according to a substrate type (holes in brickwork substrate made of hollow or autoclaved aerated concrete blocks should be drilled using a drill without impact)
5. Diameter of drilled holes should match diameter of the plugs used
6. Drilled holes in substrates of solid materials should be deeper by min. 10mm compared to the plug anchorage depth
7. Clean the holes in solid materials of drillings with a back and forth motion of the drill at a reduced speed
8. Then insert the plug into a drilled hole, and drive the screw until it completely penetrates the sleeve (pre-fastening installation)

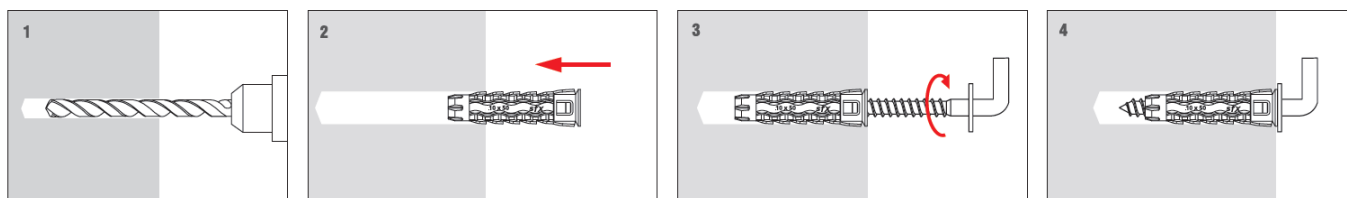

PRODUCT DATA SHEET – SFXL/SFXC/SFXO

Section 3. TECHNICAL DATA

TECHNICAL PARAMETERS				
Parameter	Unit	Value		
		SFXL	SFXC	SFXO
Plug diameter	d_k [mm]	6/8		
Hole/drill diameter	d_o [mm]	6/8		
Effective anchorage depth*	h_{eff} [mm]	30/40		
Drilled hole depth	h_o [mm]	40/50		
Sleeve material	[-]	PA - polyamide		
Screw material	[-]	Zinc-plated steel		
National Technical Assessment	[-]	ITB-KOT-2021/1847 edition 1		

*for plasterboards and fibre-cement boards, h_{eff} = board thickness

RESISTANCE		
Substrate type	Characteristic pull-out resistance from the substrate and shear [kN]	
	6x30	8x40
Concrete C20/25 – C50/60	0,2	0,3
Solid clay brick	0,4	0,6
Solid sand-lime brick	0,4	0,6
Hollow clay brick	0,4	0,6
Hollow sand-lime brick	0,4	0,6
Autoclaved aerated concrete	0,4	0,6
Plasterboard 12.5mm	0,2	0,2
Fibre-cement board 12.5mm	0,2	0,2

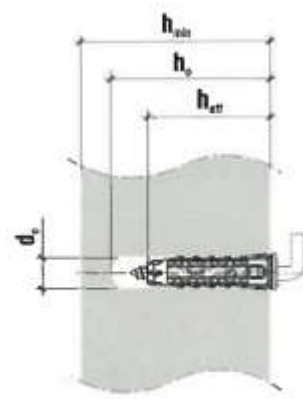
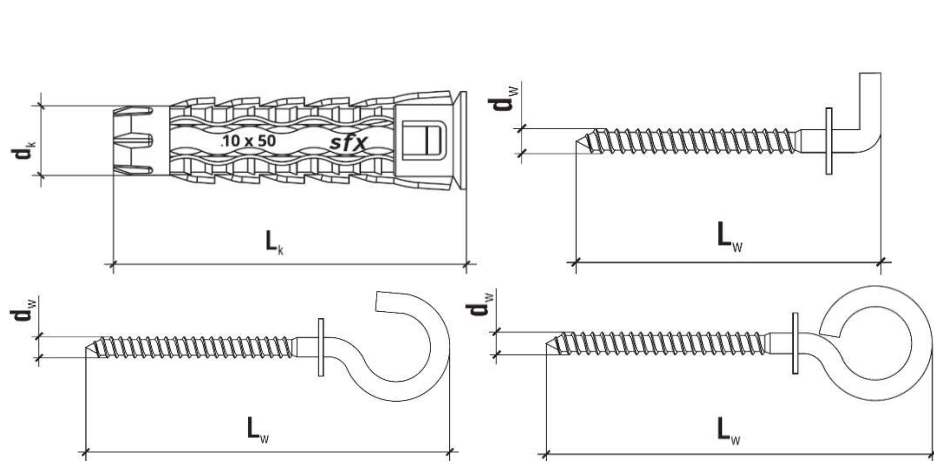

SELECTION TABLE			
Product code	Sleeve diameter and length	Screw diameter and length	Number of pieces in a box
	$d_k \times L_k$ [mm]	$d_w \times L_w$ [mm]	[pcs]
SFXL-06030048	6x30	3,5x48	50
SFXL-08040065	8x40	4,5x65	25
SFXC-06030065	6x30	3,5x65	50
SFXC-08040083	8x40	4,5x83	25
SFXO-06030064	6x30	3,5x64	50
SFXO-08040085	8x40	4,5x85	25

Section 4. REMARKS

1. All previous versions of this Product Data Sheet shall cease to be valid
2. Data given in this Product Data Sheet is in accordance with current knowledge and published in good faith. KLIMAS Sp. z o.o. is not responsible for correctness and quality of the fixing if recommendations regarding method of use and installation are not followed.