

PRODUCT DATA SHEET – MHP

Section 1. PRODUCT DESCRIPTION

“MOLLY” STEEL ANCHOR WITH STRAIGHT HOOK – MHP

Steel anchor with straight hook MHP is made of steel with zinc chromate coating. It is used for medium duty fixing of interior finish products in plasterboards and chipboards. After being fixed, collapsing arms form a large support surface on the reverse side of the plasterboard. Sharp flange barbs prevent the rotation of anchor shell during fixing which, ensures correct installation.

Types of substrates on which anchor MHP can be installed:

- Plasterboard
- Chipboard



Section 2. METHOD OF INSTALLATION

1. Original anchors delivered by the manufacturer can be used only
2. Before installation identify a substrate in which the anchor will be installed and compare loads which the anchor will carry to the resistance values
3. Select adequate anchor length, depending on sum of thickness values of members being fixed
4. Holes in plasterboard should be drilled using drilling bits for timber or steel in order not to damage structure of the board
5. Diameter of drilled holes should match diameter of the anchors used

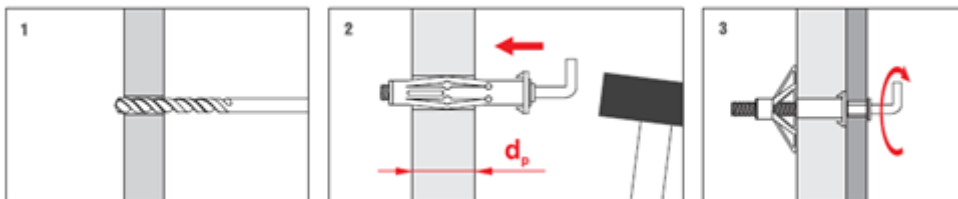

Section 3. TECHNICAL DATA

Product code	RESISTANCE		
	Characteristic/design resistance in 9.5 mm plasterboard	Characteristic/design resistance in 12.5 mm plasterboard	Characteristic/design resistance in 10 mm chipboard
	[kN]	[kN]	[kN]
MHP-M4	0,37/0,17	0,40/0,18	0,62/0,28
MHP-M5	0,53/0,24	0,78/0,35	1,28/0,58

SELECTION TABLE					
Product code	Fastener diameter and length	Hole diameter	Shank length	Drywall thickness range	Number of pieces in a box
	$d_w \times L_w$ [mm]	d_o [mm]	L_k [mm]	d_p [mm]	[pcs]
MHP-04032	M4 x 38	9	32	6-12	100
MHP-05052	M5 x 58	11	52	12-16	50

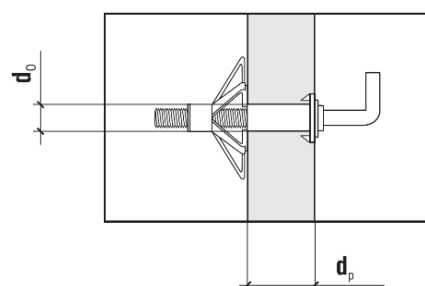
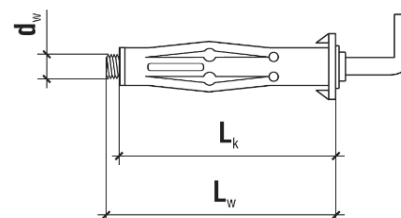

PRODUCT DATA SHEET – MHP

Section 4. REMARKS

1. All previous versions of this Product Data Sheet shall cease to be valid
2. Data given in this Product Data Sheet is in accordance with current knowledge and published in good faith. KLIMAS Sp. z o.o. is not responsible for correctness and quality of the fixing if recommendations regarding method of use and installation are not followed.