

## PRODUCT DATA SHEET – MOL

### Section 1. PRODUCT DESCRIPTION

#### “MOLLY” STEEL ANCHOR – MOL

Steel anchor MOL is made of steel with zinc chromate coating. It is used for medium duty fixing of interior finish products in plasterboards and chipboards. After being fixed, collapsing arms form a large support surface on the reverse side of the plasterboard. Sharp flange barbs prevent the rotation of anchor shell during fixing which, ensures correct installation.

Types of substrates on which fastener MOL can be installed:

- Plasterboard
- Chipboard



### Section 2. METHOD OF INSTALLATION

1. Original anchors delivered by the manufacturer can be used only
2. Before installation identify a substrate in which the anchor will be installed and compare loads which the anchor will carry to the resistance values
3. Select adequate anchor length, depending on sum of thickness values of members being fixed
4. Holes in plasterboard should be drilled using drilling bits for timber or steel in order not to damage structure of the board
5. Diameter of drilled holes should match diameter of the anchors used
6. Anchor should be installed using “Molly” anchor setting tool HT, cordless or manual screwdriver

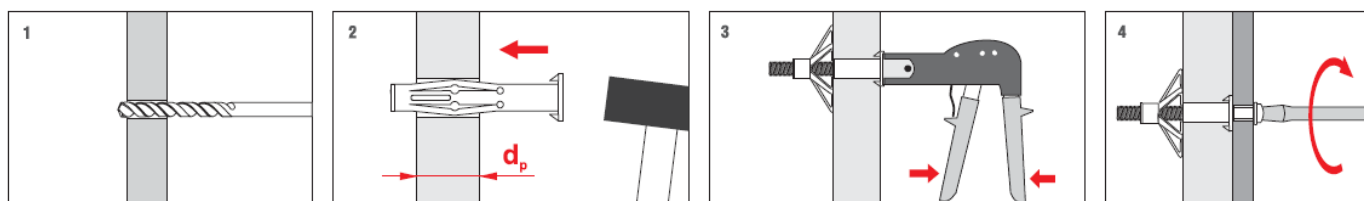

### Section 3. TECHNICAL DATA

Product code	RESISTANCE			
	Characteristic/design resistance in 9.5 mm plasterboard [kN]	Characteristic/design resistance in 12.5 mm plasterboard [kN]	Characteristic/design resistance in 2x12.5 mm plasterboard [kN]	Characteristic/design resistance in 10 mm chipboard [kN]
MOL-M4	0,37/0,17	0,40/0,18	0,46/0,21	0,62/0,28
MOL-M5	0,53/0,24	0,78/0,35	0,86/0,39	1,28/0,58
MOL-M6	0,60/0,27	0,95/0,43	1,40/0,63	1,95/0,88

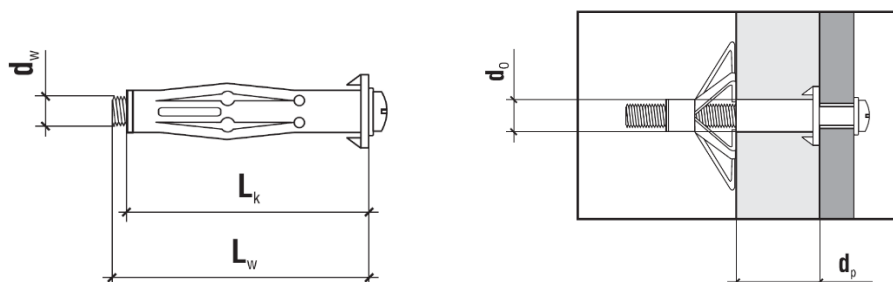

## PRODUCT DATA SHEET – MOL

SELECTION TABLE					
Product code	Dimensions	Hole diameter	Shank length	Drywall thickness range	Number of pieces in a box
	d <sub>w</sub> x L <sub>w</sub> [mm]	d <sub>o</sub> [mm]	L <sub>k</sub> [mm]	d <sub>p</sub> [mm]	[pcs]
MOL-04025	M4 x 25	7	19	2-6	100
MOL-04038	M4 x 38	7	32	6-12	100
MOL-04045	M4 x 45	7	38	13-16	100
MOL-04052	M4 x 52	7	45	20-24	100
MOL-04065	M4 x 65	7	54	27-33	100
MOL-04071	M4 x 71	7	65	33-39	100
MOL-05045	M5 x 45	9	37	6-12	100
MOL-05058	M5 x 58	9	52	12-16	50
MOL-05071	M5 x 71	9	65	24-32	50
MOL-05088	M5 x 88	9	80	38-45	50
MOL-06045	M6 x 45	11	37	7-12	50
MOL-06058	M6 x 58	11	52	10-16	50
MOL-06071	M6 x 71	11	65	24-32	50
MOL-06088	M6 x 88	11	80	38-45	50

### Section 4. REMARKS

1. All previous versions of this Product Data Sheet shall cease to be valid
2. Data given in this Product Data Sheet is in accordance with current knowledge and published in good faith. KLIMAS Sp. z o.o. is not responsible for correctness and quality of the fixing if recommendations regarding method of use and installation are not followed.